

Julia Chiang
Holding my breath moving closer closer
The Modern Institute, Osborne Street
30th September – 6th November

For her second solo exhibition at The Modern Institute, Brooklyn-based artist Julia Chiang presents a new body of paintings and framed watercolours in the gallery's Osborne Street location.

Chiang is known for her detailed paintings which take flat-colour backgrounds as a setting for an intricate web of shapes and forms, flowing in converging directions and carefully constructed through layers of paint. From an initial viewing the compositions seemingly give off the appearance of a uniform execution but upon closer study reveals the differences in transparency and definition, and at times the presence of uncertainty and chance in the painterly process.

The repetition of pointed ellipses are a prominent feature in Chiang's paintings, occupying the expanse of flat colour and creating a sense of movement, a channel of energy. Underneath, large forms appear to guide and gather the flow; or layered on top they loom above, threatening to encroach and disturb the serene pattern. The strive for pattern continuity, the ambiguity between containment and expansion, pushing between shapes and directions are reminiscent of the pushing of physical and emotional boundaries Chiang contemplates within her visual language.

The new watercolours on paper visibly share a kinship to Chiang's painted pieces, though their titles – each bestowed with a date beginning from Spring this year – suggest a reflection on the new-found (or perhaps by now familiar) change in our interactions, as if daily mediations on the circumstances. Chiang touches upon patterns disrupted or altered: simple acts such as holding hands, only to immediately follow up with washing hands; the repetitive routine of waking up to sleep – shifts that are adjusting our everyday habits, exchanges and desires.

Julia Chiang (b. 1978 Atlantic City, New Jersey, USA) lives and works in Brooklyn, New York. Selected solo exhibitions include: *Tennis Elbow*, The Journal Gallery, Brooklyn (2020); *Pump And Bump*, NANZUKA, Tokyo (2019); *Spit Sweat Shhh*, The Modern Institute, Glasgow (2019); *Hanging In, Hanging On*, New Museum Shop, New York (2014); *That Side, This Side, No Side*, Bill Brady KC, Kansas City (2013); *Coming Together, Coming Apart*, Nanzuka, Tokyo (2013); *Forever And Longer*, Colette, Paris (2012); *Security Is Mostly A Superstition*, Half Gallery, New York (2011); *Forever*, The Standard Miami Beach for Art Basel Miami Beach, Miami Beach (2010).

Recent group exhibitions include: Spring/Break Art Show, Skylight at Moynihan Station, New York (2015); They Sicken of the Calm Who Know the Storm, curated by Maureen Sullivan, Fridman Gallery, New York (2014); Spring/Break Art Show, Old School, New York (2013); It Ain't Fair, OHWOW, Miami (2012); Autumn Place, Nanzuka, Tokyo (2012); East West Shift to the Middle, Bill Brady KC, Kansas City (2012); Figured, Rotunda Gallery, Brooklyn (2012); January White Sale, curated by Beth Rudin DeWoody, Loretta Howard Gallery (2011).

Julia Chiang
'Holding My Breath Moving Closer Closer'
The Modern Institute, Osborne Street
30th September – 6th November 2020

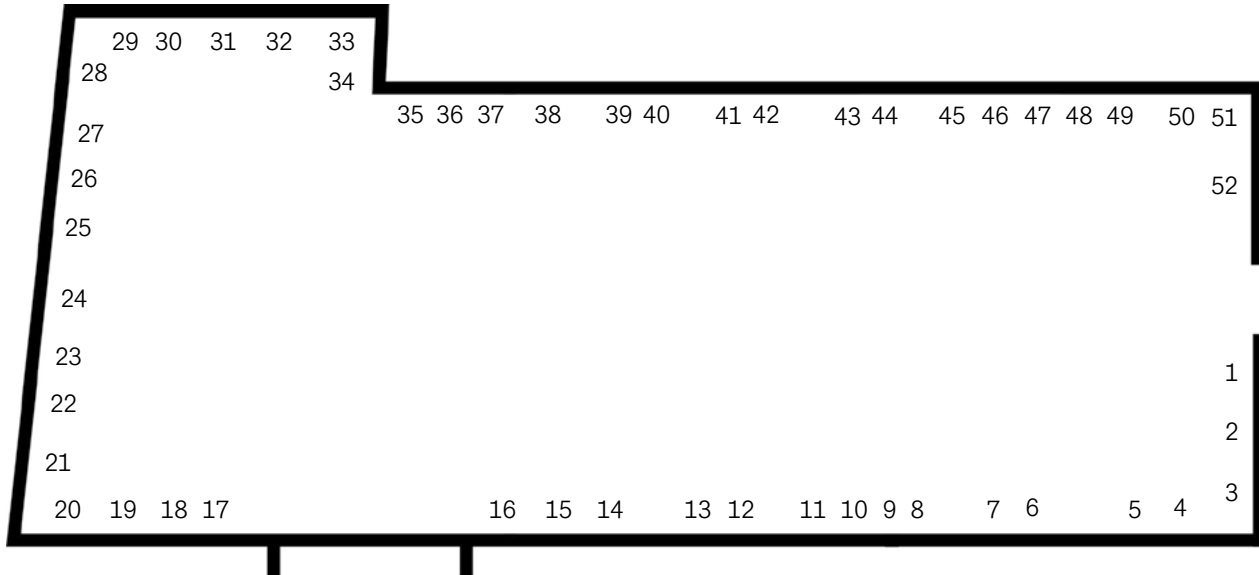

- | | | | | | |
|----|--|----|--|----|---|
| 1 | <i>May 27, 2020</i>
Watercolour on paper
32.2 x 24.5 x 3 cm
12 5/8 x 9 5/8 x 1 1/8 in | 2 | <i>Lean More, 2020</i>
Acrylic on wood panel
76.2 x 55.9 cm
30 x 22 in | 3 | <i>April 3, 2020</i>
Watercolour on paper
32.2 x 24.5 x 3 cm
12 5/8 x 9 5/8 x 1 1/8 in |
| 4 | <i>June 16, 2020</i>
Watercolour on paper
32.2 x 24.5 x 3 cm
12 5/8 x 9 5/8 x 1 1/8 in | 5 | <i>May 28, 2020</i>
Watercolour on paper
32.2 x 24.5 x 3 cm
12 5/8 x 9 5/8 x 1 1/8 in | 6 | <i>April 4, 2020</i>
Watercolour on paper
32.2 x 24.5 x 3 cm
12 5/8 x 9 5/8 x 1 1/8 in |
| 7 | <i>Storm Shake, 2020</i>
Acrylic on wood panel
167.6 x 121.9 cm
66 x 48 in | 8 | <i>April 28, 2020</i>
Watercolour on paper
32.2 x 24.5 x 3 cm
12 5/8 x 9 5/8 x 1 1/8 in | 9 | <i>July 2, 2020</i>
Watercolour on paper
32.2 x 24.5 x 3 cm
12 5/8 x 9 5/8 x 1 1/8 in |
| 10 | <i>April 12, 2020</i>
Watercolour on paper
32.2 x 24.5 x 3 cm
12 5/8 x 9 5/8 x 1 1/8 in | 11 | <i>July 29, 2020</i>
Watercolour on paper
32.2 x 24.5 x 3 cm
12 5/8 x 9 5/8 x 1 1/8 in | 12 | <i>Hokey Pokey, 2020</i>
Acrylic on wood panel
101.6 x 76.2 cm
40 x 30 in |

Julia Chiang
'Holding My Breath Moving Closer Closer'
The Modern Institute, Osborne Street
30th September – 6th November 2020

- | | | |
|--|--|--|
| 13 <i>Open Up</i> , 2020
Acrylic on wood panel
76.2 x 55.9 cm
30 x 22 in | 14 <i>April 9</i> , 2020
Watercolour on paper
32.2 x 24.5 x 3 cm
12 5/8 x 9 5/8 x 1 1/8 in | 15 <i>June 4</i> , 2020
Watercolour on paper
32.2 x 24.5 x 3 cm
12 5/8 x 9 5/8 x 1 1/8 in |
| 16 <i>July 8</i> , 2020
Watercolour on paper
32.2 x 24.5 x 3 cm
12 5/8 x 9 5/8 x 1 1/8 in | 17 <i>April 9</i> , 2020
Watercolour on paper
32.2 x 24.5 x 3 cm
12 5/8 x 9 5/8 x 1 1/8 in | 18 <i>July 29</i> , 2020
Watercolour on paper
32.2 x 24.5 x 3 cm
12 5/8 x 9 5/8 x 1 1/8 in |
| 19 <i>Thrill Moves</i> , 2020
Acrylic on wood panel
76.2 x 55.9 cm
30 x 22 in | 20 <i>May 28</i> , 2020
Watercolour on paper
32.2 x 24.5 x 3 cm
12 5/8 x 9 5/8 x 1 1/8 in | 21 <i>June 4</i> , 2020
Watercolour on paper
32.2 x 24.5 x 3 cm
12 5/8 x 9 5/8 x 1 1/8 in |
| 22 <i>June 18</i> , 2020
Watercolour on paper
32.2 x 24.5 x 3 cm
12 5/8 x 9 5/8 x 1 1/8 in | 23 <i>There No Here</i> , 2020
Acrylic on wood panel
167.6 x 121.9 cm
66 x 48 in | 24 <i>Push Free</i> , 2020
Acrylic on wood panel
76.2 x 55.9 cm
30 x 22 in |
| 25 <i>April 16</i> , 2020
Watercolour on paper
32.2 x 24.5 x 3 cm
12 5/8 x 9 5/8 x 1 1/8 in | 26 <i>May 29</i> , 2020
Watercolour on paper
32.2 x 24.5 x 3 cm
12 5/8 x 9 5/8 x 1 1/8 in | 27 <i>May 27</i> , 2020
Watercolour on paper
32.2 x 24.5 x 3 cm
12 5/8 x 9 5/8 x 1 1/8 in |
| 28 <i>June 18</i> , 2020
Watercolour on paper
32.2 x 24.5 x 3 cm
12 5/8 x 9 5/8 x 1 1/8 in | 29 <i>July 17</i> , 2020
Watercolour on paper
32.2 x 24.5 x 3 cm
12 5/8 x 9 5/8 x 1 1/8 in | 30 <i>April 10</i> , 2020
Watercolour on paper
32.2 x 24.5 x 3 cm
12 5/8 x 9 5/8 x 1 1/8 in |
| 31 <i>Shimmy In And Slide</i> , 2020
Acrylic on wood panel
167.6 x 121.9 cm
66 x 48 in | 32 <i>May 29</i> , 2020
Watercolour on paper
32.2 x 24.5 x 3 cm
12 5/8 x 9 5/8 x 1 1/8 in | 33 <i>June 18</i> , 2020
Watercolour on paper
32.2 x 24.5 x 3 cm
12 5/8 x 9 5/8 x 1 1/8 in |
| 34 <i>July 6</i> , 2020
Watercolour on paper
32.2 x 24.5 x 3 cm
12 5/8 x 9 5/8 x 1 1/8 in | 35 <i>April 16</i> , 2020
Watercolour on paper
32.2 x 24.5 x 3 cm
12 5/8 x 9 5/8 x 1 1/8 in | 36 <i>April 12</i> , 2020
Watercolour on paper
32.2 x 24.5 x 3 cm
12 5/8 x 9 5/8 x 1 1/8 in |
| 37 <i>April 15</i> , 2020
Watercolour on paper
32.2 x 24.5 x 3 cm
12 5/8 x 9 5/8 x 1 1/8 in | 38 <i>Burst Pinch</i> , 2020
Acrylic on wood panel
101.6 x 76.2 cm
40 x 30 in | 39 <i>Emergency Kiss</i> , 2020
Acrylic on wood panel
101.6 x 76.2 cm
40 x 30 in |

Julia Chiang
'Holding My Breath Moving Closer Closer'
The Modern Institute, Osborne Street
30th September – 6th November 2020

- | | | |
|--|---|--|
| <p>40 <i>April 9, 2020</i>
 Watercolour on paper
 32.2 x 24.5 x 3 cm
 12 5/8 x 9 5/8 x 1 1/8 in</p> | <p>41 <i>July 8, 2020</i>
 Watercolour on paper
 32.2 x 24.5 x 3 cm
 12 5/8 x 9 5/8 x 1 1/8 in</p> | <p>42 <i>Pull Through It All, 2020</i>
 Acrylic on wood panel
 101.6 x 76.2 cm
 40 x 30 in</p> |
| <p>43 <i>April 16, 2020</i>
 Acrylic on wood panel
 167.6 x 121.9 cm
 66 x 48 in</p> | <p>44 <i>June 8, 2020</i>
 Watercolour on paper
 32.2 x 24.5 x 3 cm
 12 5/8 x 9 5/8 x 1 1/8 in</p> | <p>45 <i>June 17, 2020</i>
 Watercolour on paper
 32.2 x 24.5 x 3 cm
 12 5/8 x 9 5/8 x 1 1/8 in</p> |
| <p>46 <i>June 8, 2020</i>
 Watercolour on paper
 32.2 x 24.5 x 3 cm
 12 5/8 x 9 5/8 x 1 1/8 in</p> | <p>47 <i>April 3, 2020</i>
 Watercolour on paper
 32.2 x 24.5 x 3 cm
 12 5/8 x 9 5/8 x 1 1/8 in</p> | <p>48 <i>April 15, 2020</i>
 Watercolour on paper
 32.2 x 24.5 x 3 cm
 12 5/8 x 9 5/8 x 1 1/8 in</p> |
| <p>49 <i>April 28, 2020</i>
 Watercolour on paper
 32.2 x 24.5 x 3 cm
 12 5/8 x 9 5/8 x 1 1/8 in</p> | <p><i>April 10, 2020</i>
 Watercolour on paper
 32.2 x 24.5 x 3 cm
 12 5/8 x 9 5/8 x 1 1/8 in</p> | <p><i>May 29, 2020</i>
 Watercolour on paper
 32.2 x 24.5 x 3 cm
 12 5/8 x 9 5/8 x 1 1/8 in</p> |
| <p>52 <i>Boing Boing, 2020</i>
 Acrylic on wood panel
 101.6 x 76.2 cm
 40 x 30 in</p> | | |